

SANQI STEEL FIBER

LOOSE HOOK END STEEL FIBER

In order to suppress the expansion of cracks inside the concrete, reducing the brittleness of concrete to improve its durability, mixing steel fiber into concrete.

The hook at both ends ensure the ideal binding between the steel fiber and the concrete, greatly enhancing anchor.

Material: round cold drawn steel wire.

Wire diameter(D):0.5-1.0mm (± 0.03 mm)

Fiber length(L):25-60mm (-1mm/+0mm)

Aspect ratio L/D: 40-80

Hook length l & l: 2.5-3mm

Hook depth h & h: 1.5-2mm

Tensile strength:1100-1200Mpa

Elongation at break:<4%

Appearance: bright and clean wire

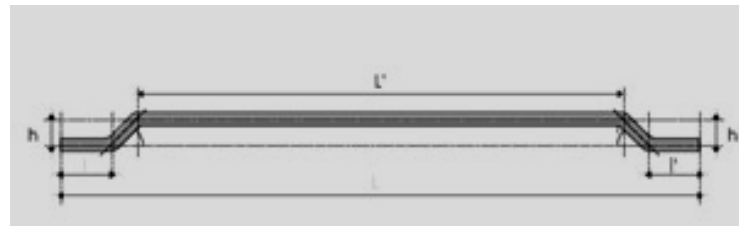

Package and storage

20kg or 25kg/damp-proof poly and paper composite bag.50bags or 40bags/pallet.

20kg or 25kg/carbon,50 or 40 cartons/pallet.

1 ton/big PE bag, then 1 ton/pallet. Also as the customer's request to make packing.

Product Standard

EN14889-1type1 SATM A820/A820M-04 type1 YB/T5294-2009

Dosage

15kg-20kg/M3 min

Features & benefits (comparing with common concrete)

Tensile strength (%)	Against pressure (%)	Against shear (%)	Against bending (%)	Against impact (%)	Against fatigue (%)	Wear resistance (%)
50-70 ↑	8-10 ↑	50-100 ↑	120-180 ↑	200-700 ↑	50-60 ↑	25-35 ↑

Application

Industrial floor, precast, Tunnel, Bridge, Highway pavement, airport

Anping Sanqi Steel fiber & Wire mesh Co.,Ltd

E-mail: sales@sqgabion.com Website: www.sqgabion.com